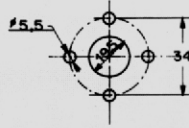
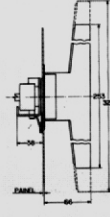
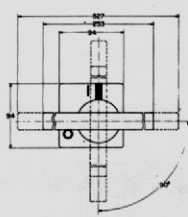

ACIONAMENTO "B"

(c/manoplas T1 e T2)

Espelho frontal de alumínio.

Travamento de porta (a porta do painel abre apenas na posição "desligado").

Matriz de furação
Drilling jig**DRIVING "B"**

(w/hand levers T1 and T2)

Aluminium frontal plate.

Locking of the door (the panel's door opens only in "off" position).

Manopla T1: para ICF 125, 160, 250 e 400/ICS 200, 250, 400 e 600/ICP 250TR, 400TR, 630TR, 800TR e 1000TR.

Manopla T2: para ICF 630 e 800/ICSF 1000/ICS 630, 800 e 1000/ICP 1250 e 1600.

Hand lever T1: to ICF 125, 160, 250 and 400/ICS 200, 250, 400 and 600/ICP 250TR, 400TR, 630TR, 800TR and 1000TR.

Hand lever T2: to ICF 630 and 800/ICSF 1000/ICS 630, 800 and 1000/ICP 1250 and 1600.

ACIONAMENTO "C"

(c/manoplas B1, B2, T1 e T2)

Espelho frontal em acrílico.

Travamento com cadeado (permite o travamento com até 3 cadeados) na posição "desligado".

Travamento de porta (abre apenas na posição "desligado").

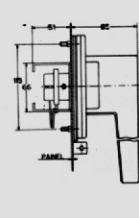
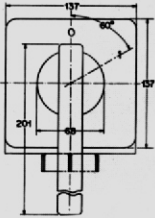
Matriz de furação
Drilling jig**DRIVING "C"**

(w/hand levers B1, B2, T1 and T2)

Acrylic frontal plate.

Locking with padlock (can be used until 3 padlock) in "off" position.

Locking of the door (only opens in "off" position).

Todas as chaves, exceto ICF 63, ICF 125TR, ICS 63 e ICS 125.
All switches, except ICF 63, ICF 125TR, ICS 63 and ICS 125.**ACIONAMENTO "D"**

(c/manoplas B1, B2, T1 e T2)

Espelho frontal de acrílico.

Travamento de porta (abre apenas na posição "desligado").

Pode ser equipado com dispositivo de travamento com cadeado, conforme acionamento C.

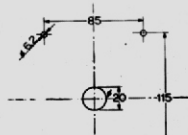
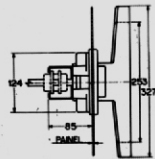
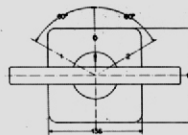
Matriz de furação
Drilling jig**DRIVING "D"**

(w/hand levers B1, B2, T1 and T2)

Acrylic frontal plate.

Locking of the door (only opens in "off" position).

Can be supplied with a locking dispositive by padlock, as driving C.

Todas as chaves, exceto ICF 63, ICF 125TR, ICS 63 e ICS 125.
All switches, except ICF 63, ICF 125TR, ICS 63 and ICS 125.**ACIONAMENTO "E"**

(c/manoplas B1, B2, T1 e T2)

Igual ao acionamento D, porém com fechadura (travamento Kirk).

Travamento em qualquer posição.

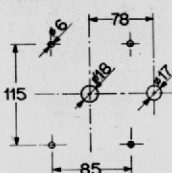
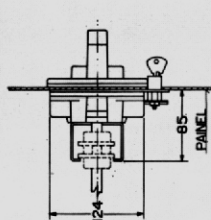
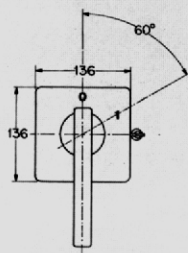
Matriz de furação
Drilling jig**DRIVING "E"**

(w/hand levers B1, B2, T1 and T2)

The same as driving D, but with a cylinder lock (Kirk).

Locking in any position.

Todas as chaves, exceto ICF 63, ICF 125TR, ICS 63 e ICS 125.
All switches, except ICF 63, ICF 125TR, ICS 63 and ICS 125.